

SPCIE-5100DX

Full-size PICMG 1.3 CPU card supports dual socket LGA 771 Intel® Xeon® processors and comes with VGA, Dual GbE, SATA II with RAID function, USB 2.0

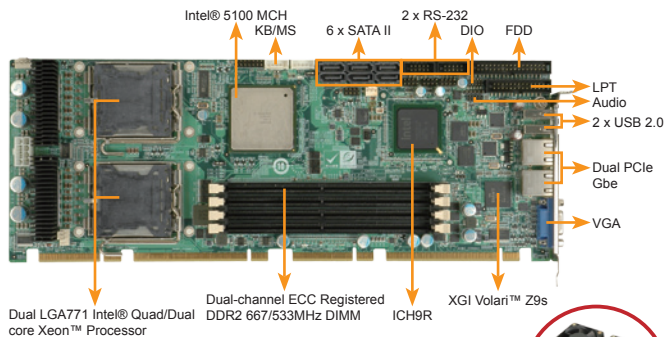

CPU Cooler
(P/N: 19100-000110-00-RS)

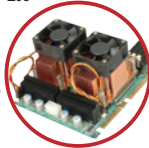

SPCIE-5100P

Full-size PICMG 1.3 CPU card supports socket P Intel® 45nm Core™2 Duo processors and comes with VGA, Dual PCIe GbE, SATA II with RAID function, USB and Audio

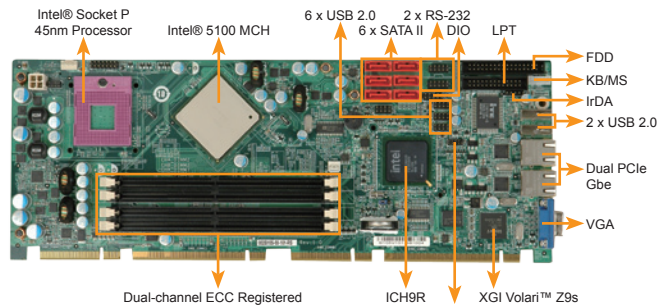

Features

1. Full-size PICMG 1.3 CPU card with Intel® 5100 server grade chipset solution
2. Dual LGA 771 Intel® Quad/Dual core Xeon® processor with a 1333MHz FSB
3. Intel® 5100 server-grade platform supports six PCIe x4 lanes for flexible PCIe application
4. ULV XGI Volari Z9s Graphics controller supports VGA output
5. Four 240-pin DDR2 ECC Registered DIMM supported up to 32GB
6. Six SATA II with RAID function improved performance and reliability for systems
7. IEI One Key Recovery solution allows you to create rapid OS backup and recovery

Specifications

- ◆ CPU
 - Dual-Core Intel® Xeon® 5100/5200 series CPU with a 1333/1066MHz FSB
 - Quad-Core Intel® Xeon® 5300/5400 series CPU with a 1333/1066MHz FSB
- ◆ Processor Package: LGA771 (Socket J)
- ◆ System Chipset
 - Intel® 5100 MCH (San Clemente) + ICH9R chipsets
- ◆ BIOS
 - AMI BIOS
- ◆ System Memory
 - Four 240-pin 667/533 MHz dual-channel DDR2 ECC Registered DIMMs supported (system max. 32GB)
- ◆ Ethernet
 - Dual PCIe Ethernet support by Intel® 82574L GbE
- ◆ I/O Interface
 - 1 x LPT
 - 1 x FDD
 - 2 x 5-pin headers for KB/MS
 - 6 x SATA II with RAID 0, 1, 5 and 10
 - 12 x USB 2.0 (Two on the bracket, six on board and four on backplane by pin header)
- ◆ Digital I/O
 - 8-bit digital I/O, 4-bit input/4-bit output
- ◆ Infrared
 - 1 x Infrared by pin header
- ◆ Super I/O: ITE IT8718F
- ◆ Display Interface
 - D-sub analog output via XGI Volari™ Z9s PCI graphics controller integrated 64MB DDR memory
 - Supports resolution up to UXGA (1600x1200) and CRT hot plug
- ◆ Audio
 - 7.1 channel HD audio kit with Realtek ALC888 codec supports dual audio streams
- ◆ Watchdog Timer
 - Software programmable supports 1 ~ 255 sec. system reset
- ◆ Power Supply
 - ATX Power
- ◆ Power Consumption
 - 3.3V@1.07A, 5V@5.55A, 12V@12.3A (Dual Intel® Xeon® 5110 1.6GHz processor with 8GB DDR2 667MHz)
- ◆ Temperature
 - Operation: 0°C ~ 60°C (32°F~140°F)
 - Operation: 0°C ~ 55°C (For 80W CPU limitation)
- ◆ Humidity
 - Operation: 5% ~ 95%, non-condensing
- ◆ Dimensions: 338 mm x 126 mm
- ◆ Weight: GW: 1500 g/NW: 1200 g

Packing List

1 x SPCIE-5100DX single board computer	
1 x ATX 12V power cable (P/N: 32102-008000-100-RS)	
2 x LGA771 CPU cooler (P/N: 19100-000110-00-RS)	
1 x Dual RS-232 cable (P/N: 19800-000051-RS)	1 x SBC support bracket
6 x SATA cable (P/N: 32801-000703-200-RS)	1 x Mini jumper pack
1 x Dual USB cable (P/N: 19800-003100-200-RS)	1 x Utility CD
1 x One Key Recovery CD	1 x QIG

Ordering Information

Part No.	Description
SPCIE-5100DX-R10	Full-size PICMG 1.3 Server Grade CPU card supports Dual Intel® Xeon Dual/Quad core processors, Intel® 5100 and ICH9R with VGA, Dual GbE, USB and SATA RAID
AC-KIT-888HD-R10	7.1 channel HD audio kit with Realtek ALC888 supports dual audio streams
32229-000100-100-RS	FDD cable
19800-000400-100-RS	LPT cable
19800-000066-RS	KB/MS cable with bracket
32102-000100-200-RS	SATA power cable

Features

1. Full-size PICMG 1.3 server grade solution
2. Intel® 45nm socket P Core™2 Duo processor with a 1066 MHz FSB
3. Intel® 5100 server-grade platform supports six PCIe x4 lanes for flexible PCIe application
4. ULV XGI volari Z9s graphics controller supports VGA output
5. Four 240-pin DDR2 ECC Registered DIMM supported
6. Six SATA II with RAID 0/1/5/10 support
7. IEI One Key Recovery solution allows you to create rapid OS backup and recovery

Specifications

- ◆ CPU
 - Socket P Intel® Core™2 Duo processors with a 1066 MHz FSB
- ◆ System Chipset
 - Intel® 5100 MCH + ICH9R chipsets
- ◆ BIOS
 - AMI BIOS
- ◆ System Memory
 - Four 240-pin 667/533 MHz dual-channel DDR2 ECC Registered DIMMs supported (system max. 8GB)
- ◆ Ethernet
 - Dual PCIe Ethernet support by Intel® 82574L GbE
- ◆ I/O Interface
 - 2 x RS-232
 - 1 x FDD
 - 6 x SATA II with RAID 0, 1, 5 and 10
 - 12 x USB 2.0 (Two on the bracket, six on SBC and four on backplane by pin header)
- ◆ Digital I/O
 - 8-bit digital I/O, 4-bit input/4-bit output
- ◆ Infrared Interface
 - 1 x Infrared by pin header
- ◆ Super I/O
 - ITE IT8718F
- ◆ Display Interface
 - VGA support by XGI Volari Z9s graphics controller
 - Supports VGA resolution up to 1600x1200
- ◆ Audio
 - Supports by 7.1 channel HD Audio Kit
- ◆ Watchdog Timer
 - Software programmable supports 1 ~ 255 sec. system reset
- ◆ Power Supply
 - ATX Power
- ◆ Power Consumption
 - 3.3V@0.62A, 5V@4.69A, 12V@2.32A (Intel® Core™2 Duo P8600 2.4GHz 1066MHz FSB CPU with 8GB 667MHz DDR2 memory)
- ◆ Temperature
 - Operation: 0°C ~ 60°C (32°F~140°F)
- ◆ Humidity
 - Operation: 5% ~ 95%, non-condensing
- ◆ Dimensions: 338 mm x 126 mm
- ◆ Weight: GW: 1200 g/NW: 420 g

Packing List

1 x SPCIE-5100P single board computer	
6 x SATA cable (P/N: 32801-000703-200-RS)	
1 x Dual RS-232 cable (P/N: 19800-000051-RS)	
1 x USB cable (P/N: 19800-003100-200-RS)	
1 x One Key Recovery CD	1 x Utility CD
1 x Mini jumper pack	1 x QIG

Ordering Information

Part No.	Description
SPCIE-5100P-R10	Full-size PICMG 1.3 CPU card supports socket P Intel® 45nm Core™2 Duo processors and comes with VGA, Dual PCIe GbE, SATA II with RAID function, USB and Audio
CF-479B-RS	CPU cooler (50mm x 50mm x 26mm, 50W)
AC-KIT-888HD-R10	7.1 channel HD audio kit with Realtek ALC888 supports dual audio streams
32229-000100-100-RS	FDD cable
19800-000400-100-RS	LPT cable
19800-000075-RS	KB/MS cable with bracket
32102-000100-200-RS	SATA power cable

Intel® Xeon® Processor Suggestion Table

Processor Number	Process	Clock Speed (GHz)	FSB (MHz)	L2 Cache	TDP	Cores
L5430	45nm	2.66GHz	1333MHz	12MB	50W	4
L5420	45nm	2.5GHz	1333MHz	12MB	50W	4
L5410	45nm	2.33GHz	1333MHz	12MB	50W	4
L5408	45nm	2.13GHz	1066MHz	12MB	40W	4
L5320	65nm	1.86GHz	1066MHz	8MB	50W	4
L5318	65nm	1.6GHz	1066MHz	8MB	45W	4
L5310	65nm	1.6GHz	1066MHz	8MB	50W	4
L5248	45nm	3.0GHz	1333MHz	6MB	55W	2
L5240	45nm	3.0GHz	1333MHz	6MB	40W	2
L5238	45nm	2.66GHz	1333MHz	6MB	35W	2
L5215	45nm	1.86GHz	1066MHz	6MB	20W	2
E5450	45nm	3.0GHz	1333MHz	12MB	80W	4
E5440	45nm	2.83GHz	1333MHz	12MB	80W	4
E5410	45nm	2.33GHz	1333MHz	12MB	80W	4
E5405	45nm	2.0GHz	1333MHz	12MB	80W	4
E5345	65nm	2.33GHz	1333MHz	8MB	80W	4
E5335	65nm	2.0GHz	1333MHz	8MB	80W	4
E5320	65nm	1.86GHz	1066MHz	8MB	80W	4
E5310	65nm	1.6GHz	1066MHz	8MB	80W	4
E5240	45nm	3.0GHz	1333MHz	6MB	40W	2
E5220	45nm	2.33GHz	1333MHz	6MB	65W	2
E5205	65nm	1.86GHz	1066MHz	6MB	65W	2
E5160	65nm	3.0GHz	1333MHz	4MB	80W	2
E5150	65nm	2.66GHz	1333MHz	4MB	65W	2
5148	65nm	2.33GHz	1333MHz	4MB	40W	2
5140	65nm	2.33GHz	1333MHz	4MB	65W	2
5138	65nm	2.13GHz	1066MHz	4MB	35W	2
5130	65nm	2.0GHz	1333MHz	4MB	65W	2
5128	65nm	1.86GHz	1066MHz	4MB	40W	2
5120	65nm	1.86GHz	1066MHz	4MB	40W	2
5110	65nm	1.8GHz	1066MHz	4MB	65W	2

"Yellow" means long-term support

SPCIE-5100DX Dimensions

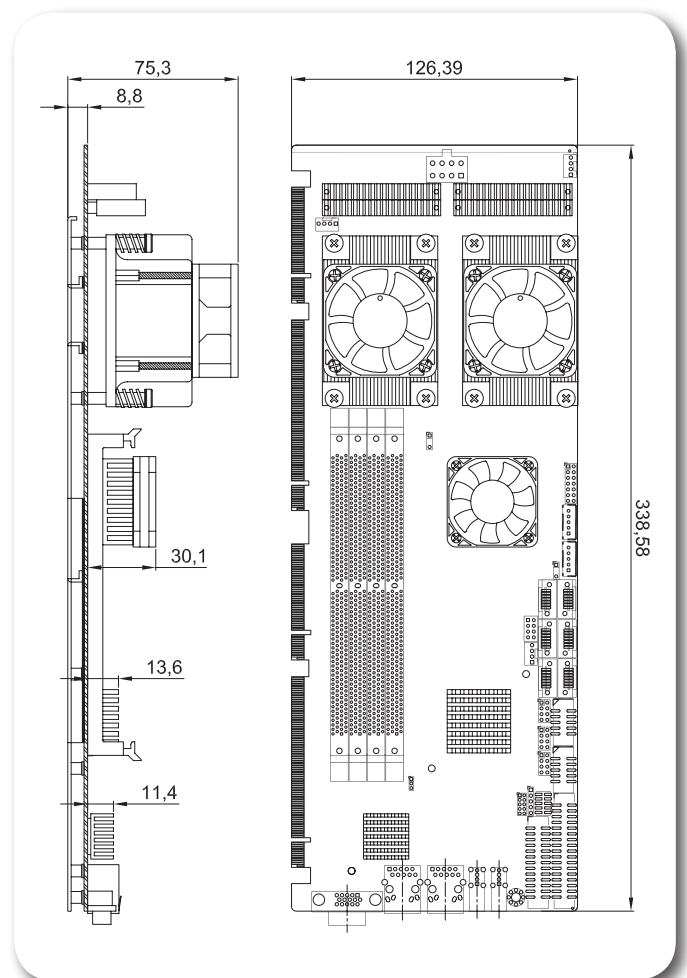

PICMG 1.3 Server Grade System Solution

There are some limitations for certain expansion slots when the SPCIE-5100DX is installed on the backplane. Please see the table below for more details.

Model	Total Slots	System	Expansion Slots					System Type
			PCIe			PCI-X	PCI	
			x16/x8	x4	x1			
SPE-4S	4	One	2*	1	-	-	-	Single
SPE-6S	6	One	-	5*	-	-	-	Single
SPE-9S	7	One	1	3	-	-	3	Single
SPXE-9S	7	One	1	2	-	2	2	Single
SPXE-14S	14	One	1*	-	12*	-	-	Single

The limitations for certain backplane expansion slots when installed with SPCIE-5100DX are listed below.

Backplanes	Slot Label	Limitations
SPE-4S	PCIEX8_1	The length of the expansion card installed in this PCIe x8 slot should be less than 21cm.
SPE-6S	PCIEX4_1	The length of the expansion card installed in these two PCIe x4 slots should be less than 21cm.
	PCIEX4_2	
SPXE-14S	PCIEX1_A1	This PCIe x1 slot is not supported by the SPCIE-5100DX
	PCIEX8_1	The length of the expansion card installed in this PCIe x8 slot should be less than 21cm.